

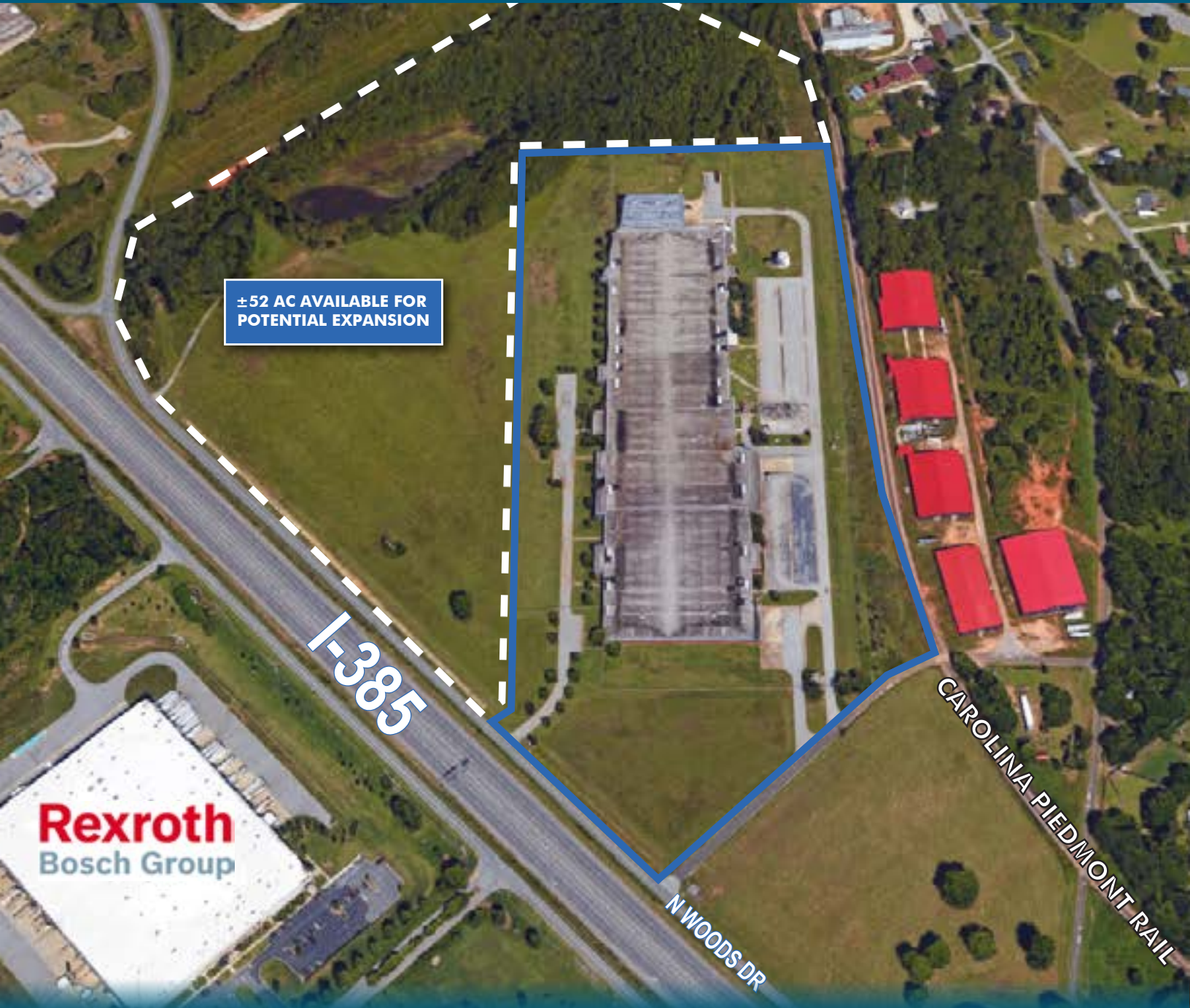

700 NORTH WOODS

Fountain Inn, SC 29644
(Former Delta Woodside Beattie Plant) **SITE #1858**

[Click Here to View Property Video](#)



±52 AC AVAILABLE FOR
POTENTIAL EXPANSION

Rexroth
Bosch Group

I-385

N WOODS DR

CAROLINA PIEDMONT RAIL

±442,503 SF AVAILABLE
RENOVATIONS UNDERWAY!



700 NORTH WOODS

700 N Woods Drive Fountain Inn, SC 29644 / Site #1858

PROPERTY OVERVIEW

- ±442,503 SF Available for Lease | ±37.60 Acres Total
 - ±52 Acres Available for Potential Expansion or Build-to-Suit
 - Tax Map ID: 0334000100406
 - Zoned Industrial | Greenville County
- Demisable Down to ±25,000 SF
- ±7,000 SF Office Area
- Lighting: LED
- Infrastructure in Place to Support Potential Data Center Use
- Power Capacity: 17,100 kW (or 17.1 MW)
- Originally Built in 1962 and Extensively Renovated in 1995
 - Highlights Include Significant Floor Improvements: Reinforced Floor Slabs with Kalman Moonrock Monolithic Stone-Densified Surface Finish and Absorption Topping
- Drive-in Doors: 1
- Dock High Doors: 9
- Clear Height: 19' - 20'
- ESRF Sprinkler System
- 32' x 40' Column Spacing
- Excellent Access to I-385 and Frontage (±1,150')
- Rail Accessible: Carolina Piedmont Railroad
- Ample Amount of Parking
- Trailer Parking Available

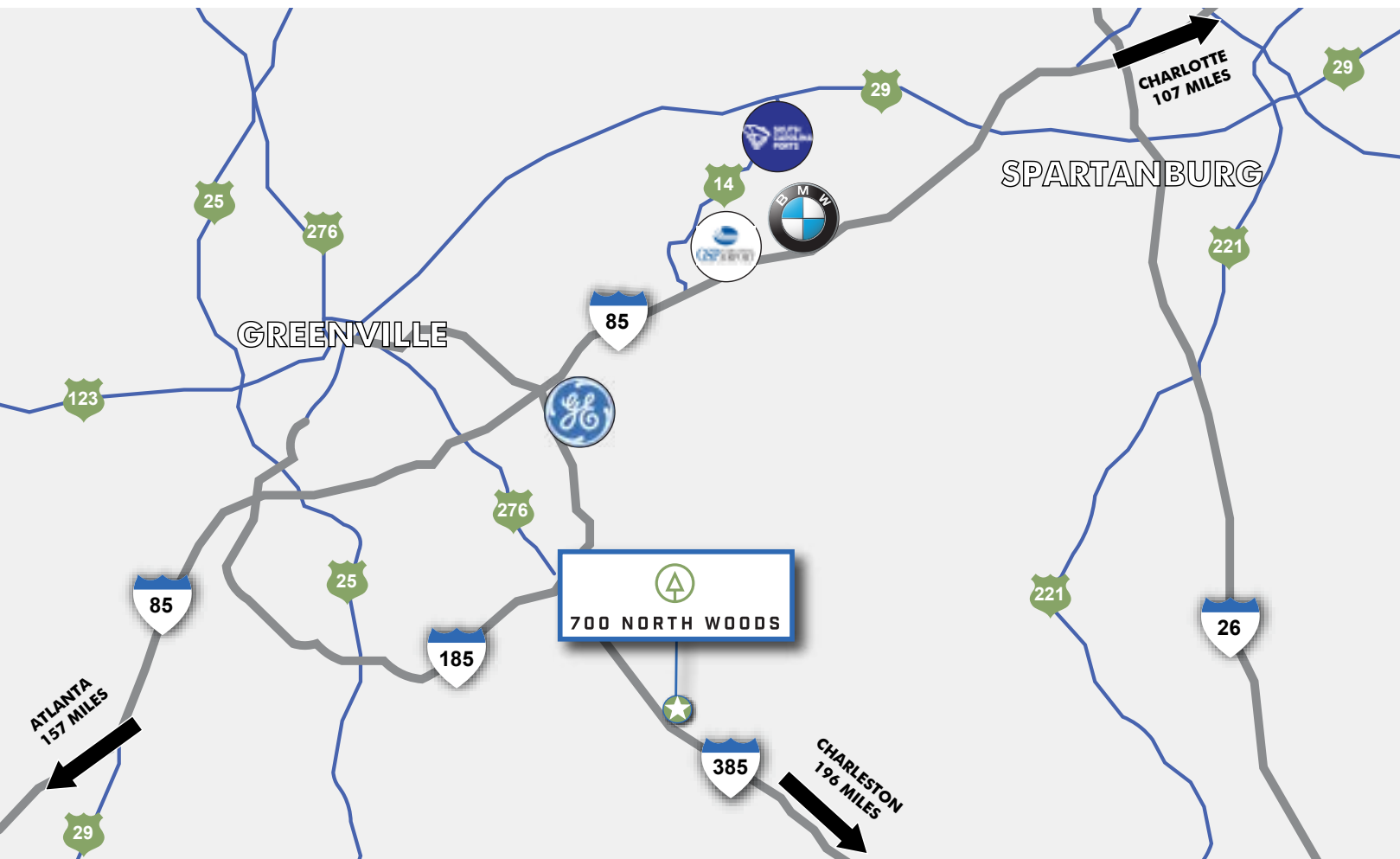

700 NORTH WOODS

700 N Woods Drive Fountain Inn, SC 29644 / Site #1858



Owner planning extensive renovations to meet current user demand



Upgrades to include LED lighting, truck court and parking surface improvements



Optional improvements to suit:

Add additional dock doors and drive-in doors

30' clear minimum

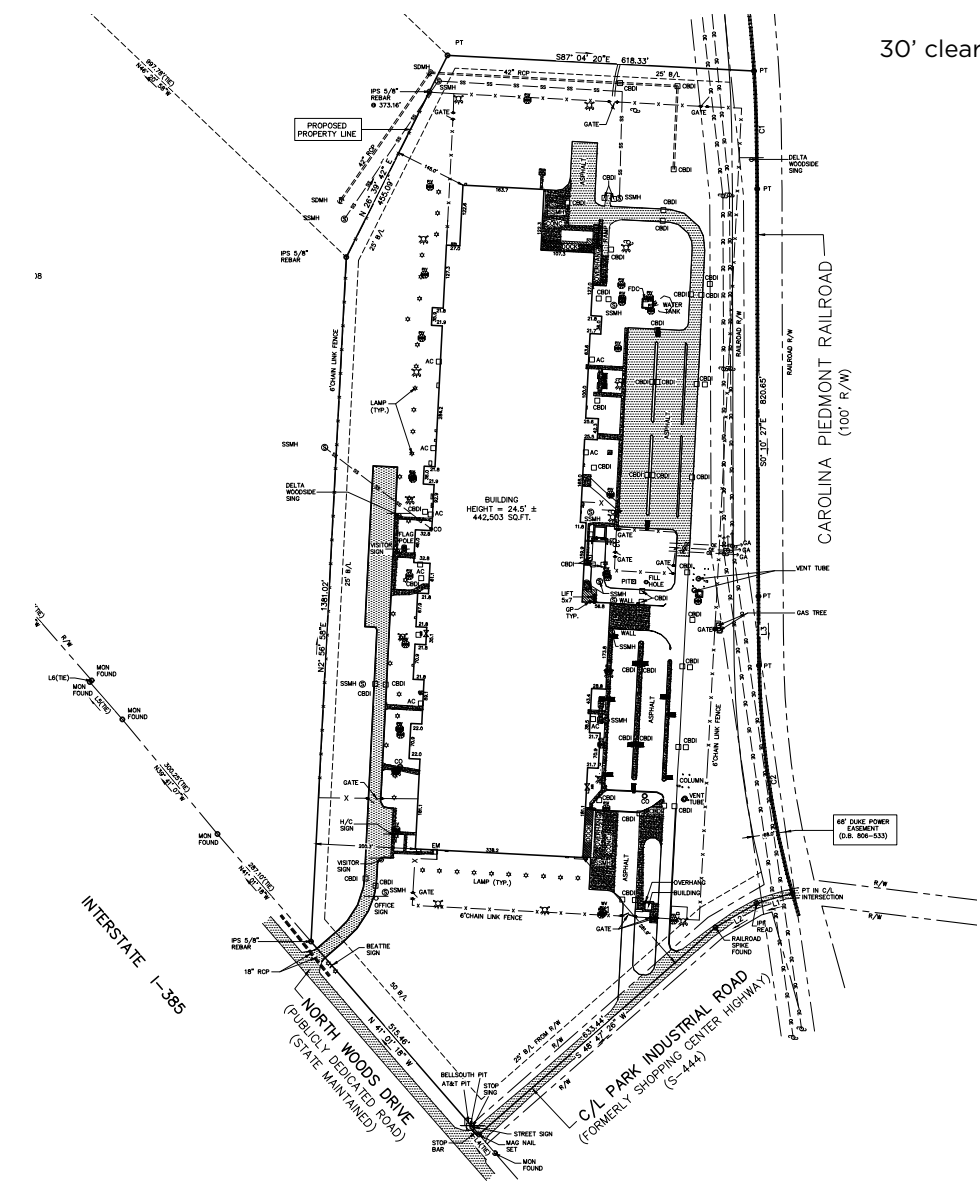



700 NORTH WOODS

Fountain Inn, SC 29644

(Former Delta Woodside Beattie Plant) **SITE #1858**



I-385: ±0.7 Mile

I-85: ±11 Miles

GSP INTERNATIONAL: ±17 Miles

BMW MANUFACTURING: ±20 Miles

SC INLAND PORT: ±23 Miles

CHARLOTTE, NC: ±107 Miles

ATLANTA, GA: ±157 Miles

PORT OF CHARLESTON: ±196 Miles

UTILITY PROVIDERS

POWER: Duke Energy - 100 kVA
Substation on site

SEWER: Western Carolina Regional

WATER: GWS (8", Gravity)

GAS: Piedmont Natural Gas

Campbell Lewis, SIOR

Vice President

+1 864 527 6041

campbell.lewis@cbre.com



© 2019 CBRE, Inc. All rights reserved. This information has been obtained from sources believed reliable, but has not been verified for accuracy or completeness. You should conduct a careful, independent investigation of the property and verify all information. Any reliance on this information is solely at your own risk. CBRE and the CBRE logo are service marks of CBRE, Inc. All other marks displayed on this document are the property of their respective owners. Photos herein are the property of their respective owners. Use of these images without the express written consent of the owner is prohibited.